

NMLC CORE BARREL

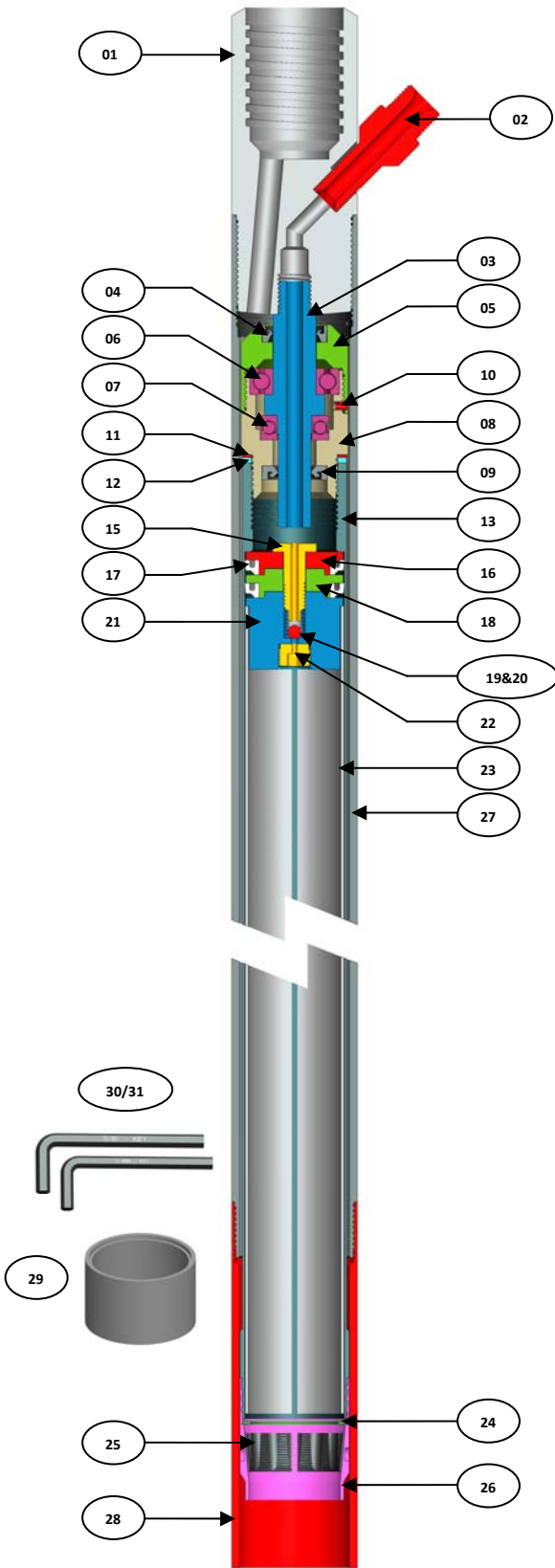

	ITEM DESCRIPTION	PART NUMBERS
1-31	NMLC CORE BARREL - 3.0m/ 10 ft	68-00-100
1-31	NMLC CORE BARREL - 1.5m/ 5 ft	68-00-110
1-10	NMLC HEAD ASSEMBLY	68-00-200
01	NMLC HEAD	68-01-001
02	WATER PUMP PLUG	66-01-002
03	SPINDLE	68-01-003
04	OIL SEAL	68-01-004
05	BEARING HOUSING CAP	68-01-005
06	BALL BEARING	68-01-006
07	THRUST BEARING	68-01-007
08	BEARING HOUSING	68-01-008
09	OIL SEAL	68-01-009
10	GRUB	66-01-010
11	SPACER 1.56 mm THICK	68-03-001
12	SPACER 3.12 mm THICK	68-03-002
13	INNER TUBE - 3.0m / 10 ft	68-03-003
13	INNER TUBE - 1.5m / 5 ft	68-03-004
14	BRASS PISTON ASSEMBLY	68-03-005
15	BRASS SCREW	66-03-006
16	BRASS WASHER I	68-03-007
17	OIL SEALS - 2 NOS.	68-03-008
18	BRASS WASHER II	68-03-009
19	SPRING	66-03-010
20	STEEL BALL	66-03-011
21	BRASS PLUG	68-03-012
22	BRASS GRUB	66-03-013
23	SPLIT TUBE - 3.0m / 10 ft	68-03-014
23	SPLIT TUBE - 1.5m / 5 ft	68-03-015
24	RING STOP	68-03-016
25	CORE LIFTER	68-03-017
26	CORE LIFTER CASE	68-03-018
27	OUTER TUBE - 3.0m / 10 ft	68-02-001
27	OUTER TUBE - 1.5m / 5 ft	68-02-002
28	THREAD PROTECTOR	68-02-003
29	BRASS PISTON GUIDE	68-02-004
30	5/16" ALLEN KEY	66-02-005
31	3MM ALLEN KEY	66-02-006

ALL KUVAWALA CORE BARRELS ARE MANUFACTURED FROM THE HIGHEST QUALITY RAW MATERIALS i.e. COLD DRAWN SEAMLESS TUBES OF GRADE SAE 1541 THAT ARE IMPORTED . THESE HAVE EXTREMELY HIGH MECHANICAL PROPERTIES AND STRAIGHTNESS BETTER THAN 1 : 2000 .

STANDARD KUVAWALA CORE BARRELS HAVE HEAT TREATED ALLOY STEEL HEADS WHICH COME WITH HARD METAL STRIPS WELDED ON THE DIAMETER OF EACH HEAD WHICH ARE 60 Rc TO 65 Rc .

THE OUTER TUBES HAVE HARD METAL STRIPS WELDED AT BOTH ENDS. THESE STRIPS HAVE HARDNESS OF 60 TO 65 Rc AND CONSIDERABLY REDUCE THE WEAR AND TEAR ON THE OUTER TUBE.

NMLC CORE BARREL SPARE PARTS KIT

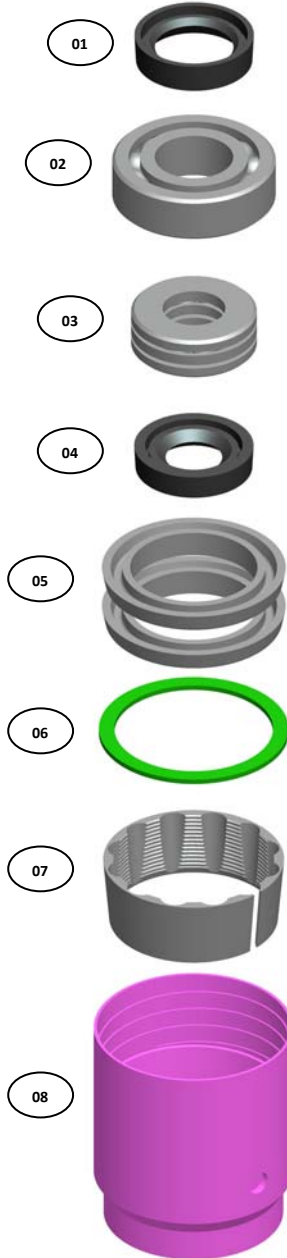

	ITEM DESCRIPTION	PART NUMBERS
1-8	NMLC CORE BARREL SPARE PARTS KIT	68-00-140
01	OIL SEAL	68-01-004
02	BALL BEARING	68-01-006
03	THRUST BEARING	68-01-007
04	OIL SEAL	68-01-009
05	OIL SEALS – 2 NOS.	68-03-008
06	RING STOP	68-03-016
07	CORE LIFTER	68-03-017
08	CORE LIFTER CASE	68-03-018